

Installation instructions

H-Fönstret Lysekil

Please include our order number at any contact with us – This will increase our ability to help you.

Delivery receipt

Transport damage and delivery defects must be stated on the delivery note. Visible errors must be reported before assembly, no later than 7 days after delivery. In addition, ABM 07 (Sweden) Incoterms 2010 (other countries) applies.

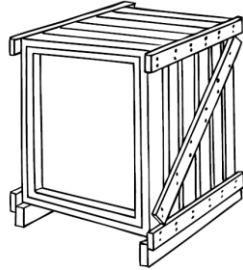

Storage at site

Store the windows standing on the pallet (or similar) and so that protruding ironmongery do not damage adjacent windows. Storage area must be dry and well ventilated.

Connection groove for flashings

The aluminium frame has an external groove for connection of drip caps and flashings. These can be screwed or riveted. **Fill the groove with sealant** before installing the drip cap or flashing. Alternatively, the side flashings can be angled and riveted or screwed directly on to the frame surface.

Opening restrictor

To open the sash more than 10cm or swing the entire sash 180 degrees, you must release the opening restrictor. It sits on the right hand side of the frame. You lift it easily, and it falls back into a locked position of its own weight. The latch also locks the window even when it is turned 180 degrees for cleaning.

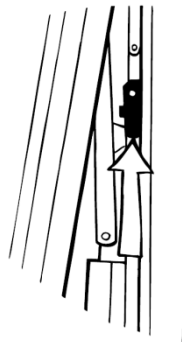

Windows and doors

The frame is predrilled for direct installation. Cover plugs are included. Install the window as close to the interior wall as possible. Level the sill using packers, one at each corner. Adjust the frame so that jambs do not lean out- or inward and then fix the window. Check (easiest in ventilation position) that the gap between the sill and the bottom of the sash is the same all the way. Retighten the installation screws and install the cover plugs. The number of installation points is equal to the number of predrilled holes. For further instructions please refer to HUS-AMA (Sweden) or local instructions and regulations.

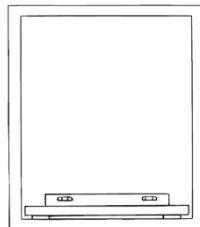

Installing a door

NOTE! When installing a door you must also use the **additional installation hole** which is situated in the aluminium frame on the hinge side (see drawing below). External pull handle should be riveted.

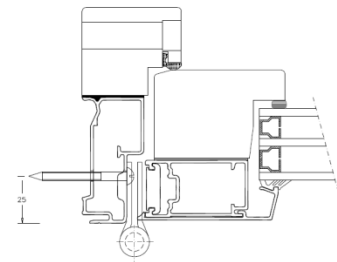
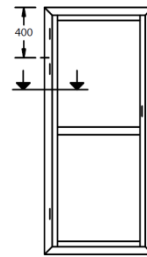

Yarn

Do not use too much yarn since it will compress the frame. On the inside you put back-up material (retainer strip) and sealant. If you use expanding polyurethane foam, keep in mind that the foam continues to expand long after application.

Protection of installed window

During the building period, the window should be well protected against any form of external impact. Ironmongery must not be exposed to paint, cement-based products or other corrosive substances. No paint on glazing gaskets, movable parts or sliding rails. Carefully protect the glass when working with welding equipment and angle grinders etc. near windows. Note the risk of damage to the window surface if foil or tape is used to protect the window. Ensure that building moisture is adequately ventilated so that the window is not damaged due to moisture.

Cleaning of glass

Avoid touching the glass surface with your fingers or dirty gloves. Use liquid window detergent, plenty of water and a soft lint-free cloth or squeegee. Hard to remove stains are removed with industrial spirits or acetone. Mild metal polish can be used to remove other stains. Please note that these products should be washed away with industrial spirits and then clean the glass with a liquid window detergent. Never use sharp metal objects or steel wool when cleaning glass (applies to all glass). **NOTE!** Keep in mind that cement-based products should not come into contact with glass surfaces.

Support from H-Fönstret

In case of doubt and questions about installing H-Fönstret from Lysekil, call +46 (0)523-66 54 50. Please also see user's and maintenance instructions at www.hfonstret.se (in Swedish). For blinds, lockable handles and other special equipment, refer to separate installation instructions supplied with these products.

Installation advantages | H-Fönstret Lysekil

[1] Simple installation

You do **not** have to open the window to access the installation holes.

Save time!

[2] No visible split damages

We drill the outer part of the installation hole 16 mm. When the frame screw engages there will be no visible split damages.

No damages!

[3] No damages from electric screw drivers

The location of the drilled installation hole prevents the electric screwdriver to damage the glass or timber.

No damages!

[4] Offset installation holes

The predrilled installation holes are vertically offset on the jambs. This means that you use the same screw for "frame-to-frame" installation as against the wall.

Save time and money!

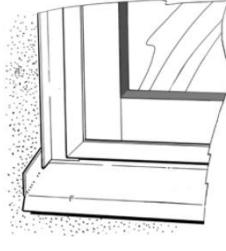
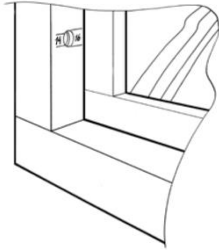

[5] Fail-safe connections

Well thought out system for external connections with mitred frame corners and grooves for flashings.

No problems with moist!

[6] Homogeneous construction

Enables secure connections to plastered walls. **No problems with moist!**

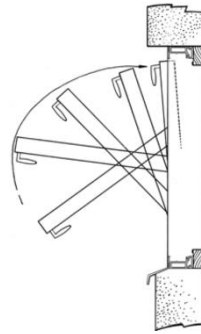
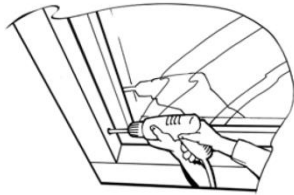

[7] No propagation

When opening the window 180 degrees the sash will enter the frame and do not hit the reveal or head.

No conflict with embrasure!

Maintenance-free windows for generations

The window from Lysekil

